

**EXPLODED PARTS DIAGRAM**

MODEL	FIG.
C-770 Ultra Zoom	1/2

Ver.1  
2004.03

**OLYMPUS CORPORATION**

A

B

C

D

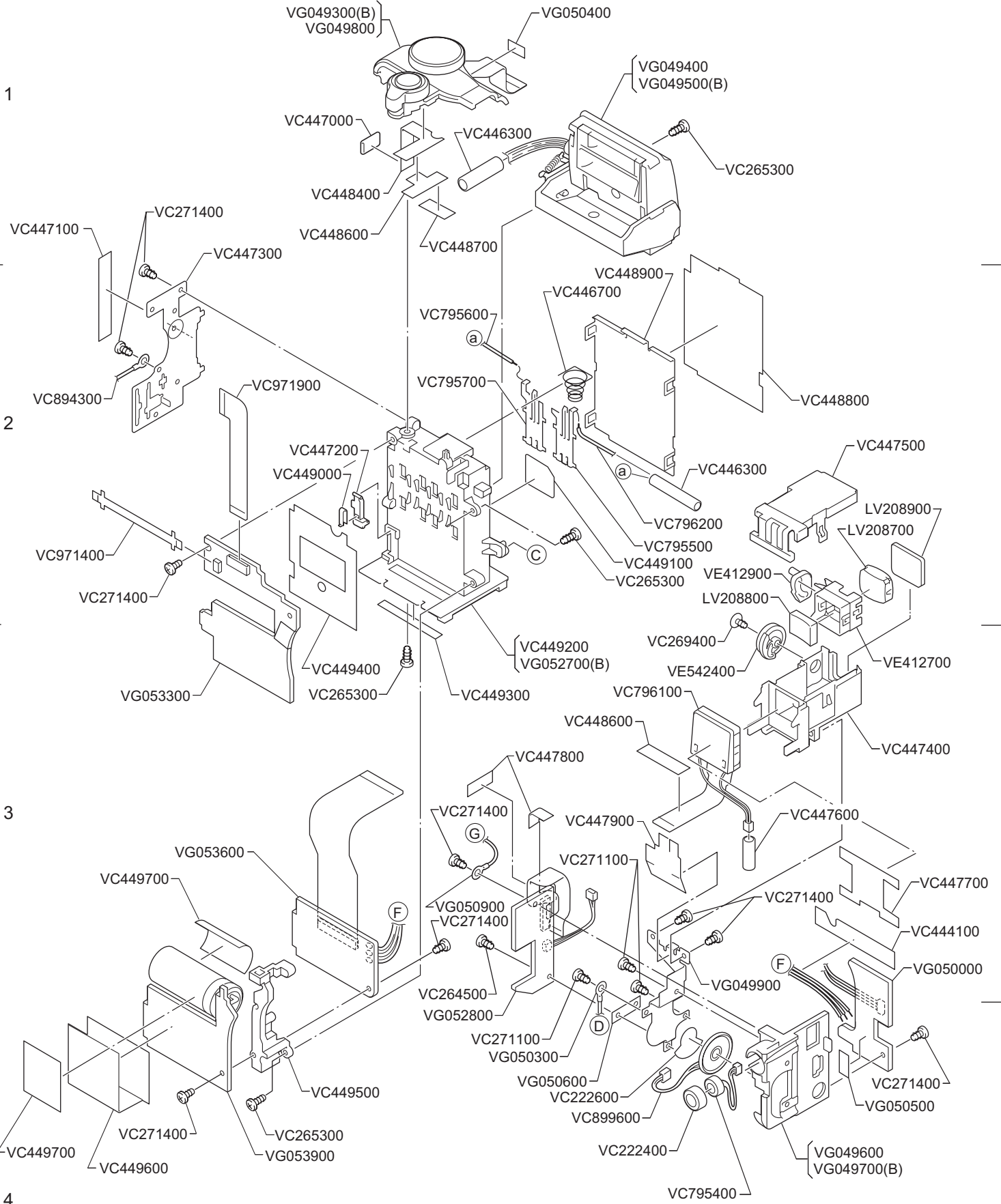

## EXPLODED PARTS DIAGRAM

MODEL	FIG.
C-770 Ultra Zoom	2/2
<b>OLYMPUS CORPORATION</b>	

Ver.1  
2004.03

PARTS LIST

C-770 Ultra Zoom

REF NO	PARTS NO	DESCRIPTION	REMARKS	NOTE
	LV208700	EVF 2-T	2-D2	
	LV208800	EVF 1-O	2-C2	
	LV208900	EVF 1-F	2-D2	
	VC222400	MIC HOLDER	2-C4	
	VC222600	SPEAKER SPACER	2-C4	
	VC253300	PUK SCREW 1.7X2.5B	1-C2	
	VC253600	PUK SCREW 1.7X4B	1-A3	
	VC253800	PUK SCREW 1.7X6B	1-C4	
	VC264500	SCREW 1.7X4B	1-B4,2-C3,C4	
	VC265300	SCREW 1.7X4	1-B3,B4,C4,2-B3,C1,C2,B4	
	VC265600	SPECIAL SCREW 1.7X2.2	1-A1,A2	
	VC266300	S SCREW 1.4X5	1-A3,B4	
	VC266500	SCREW 1.7X3B	1-A4,D2	
	VC266600	SCREW 1.7x5	1-D2	
	VC267200	SCREW 1.7x5B	1-D2	
	VC268800	PUK SCREW 1.7X3B	1-C1,B4	
	VC269400	S SCREW 1.6X3	2-C3	
	VC271100	S SCREW 1.7X3	2-C3,B4	
	VC271400	SCREW 1.7X3	1-A4,C1,D2,D3,2-A2,A4,B3,D4	
	VC271400	SCREW 1.7X3	2-A1,B3,D3	
	VC275500	PUK SCREW 1.7X5	1-D1	
	VC275700	PUK SCREW 1.7X4	1-A3	
	VC277200	PUK SCREW 1.7X5B	1-D1	
	VC443600	PUK SCREW 1.7X2.5	1-C2	
	VC443700	TAP SCREW 2X3.5	1-C2	
	VC443800	PUK SCREW 1.7X6	1-C4	
	VC443900	PUK SCREW 1.7X3	1-B4,C1	
	VC444000	SHIELD TAPE 6	1-B1,C1	
	VC444100	SPACER PLATE	2-D3	
	VC444800	4KEY BUTTON	1-C2	
	VC445100	VIEW BUTTON	1-C2	
	VC445200	ACCESS WINDOW	1-C1	
	VC445600	SHIELD TAPE 2	1-C4	
	VC446000	B PLATE	1-D4	
	VC446100	INSULATION 2	1-D2	
	VC446200	B COVER SPRING	1-D3	
	VC446300	SILICON TUBE	2-B1,C2	
	VC446400	B COVER SHAFT	1-C4	
	VC446500	SHIELD PLATE	1-B2	
	VC446600	INSULATION 1	1-D2,D3	
	VC446700	B SPRING	2-C2	
	VC446800	TRIPOD SOCKET	1-B3	
	VC446900	SELF WINDOW	1-A3	
	VC447000	PAD	2-B1	
	VC447100	LEAD HOLD TAPE	2-A1	
	VC447200	LOCK LEVER	2-B2	
	VC447300	SIDE PLATE	2-A1	

PARTS LIST

C-770 Ultra Zoom

REF NO	PARTS NO	DESCRIPTION	REMARKS	NOTE
	VC447400	F COVER	2-D3	
	VC447500	F FRAME	2-D2	
	VC447600	TUBE	2-D3	
	VC447700	LIGHT PROOF	2-D3	
	VC447800	INSULATION 9	2-C3,D3	
	VC447900	INSULATION 8	2-C3	
	VC448400	SHIELD PLATE 8	2-B1	
	VC448500	SHIELD TAPE 7	1-C4	
	VC448600	INSULATION 7	2-B1,C3	
	VC448700	INSULATION 6	2-B1	
	VC448800	B PLATE TAPE	2-D2	
	VC448900	B PLATE	2-C2	
	VC449000	LOCK LEVER SPRING	2-B2	
	VC449100	BATTERY LABEL	2-C2	
	VC449200	BATTERY CASE	2-C3	
	VC449300	CAUTION LABEL	2-B3	
	VC449400	INSULATION 5	2-B3	
	VC449500	PCB HOLDER	2-B4	
	VC449600	INSULATION 4	2-A4	
	VC449700	MAIN CON. TAPE	2-A3,A4	
	VC795400	MICROPHONE	2-C4	
	VC795500	BATTERY TERMINAL B	2-C2	
	VC795600	BATTERY LEAD(+)	2-B2	
	VC795700	BATTERY TERMINAL A	2-B2	
	VC795800	LCD	1-B1	
	VC795900	LCD LEAD	1-B2	
	VC796000	FILTER	1-B3	
	VC796100	LCD	2-C3	
	VC796200	BATTERY LEAD(-)	2-C2	
F5051	VC796600	FUSE 32V 1A	PW2	
F5001	VC796700	FUSE 32V 2A (F5002, F5003, F5004)	PW1	
JK112	VC866000	PHONE JACK	CP1	
JK551	VC866700	DC SOCKET	PW2	
CN110	VC885400	USB SOCKET	CP1	
	VC894300	TERMINAL CORD	2-A2	
	VC899600	SPEAKER	2-C4	
	VC971300	CA1FPC	1-C2	
	VC971400	TB3 FPC	2-A2	
	VC971900	TB1 FPC	2-B2	
	VE089300	CLICK BALL	1-A3,C4	
	VE209800	MOUNTING STRAP,L	1-A3	
	VE209900	MOUNTING STRAP,R	1-C4	
	VE210000	STRAP HOOK	1-A3,C4	
	VE210200	CLICK SPRING	1-A3,C4	
	VE253700	X COVER	1-C3	
	VE255800	HOLDER TERMINAL H	1-C4	
	VE255900	SPRING TERMINAL H	1-C3	

PARTS LIST

C-770 Ultra Zoom

REF NO	PARTS NO	DESCRIPTION	REMARKS	NOTE
	VE335900	SPECIAL SCREW 1.6X4.0	1-A2,B3	
	VE412700	F LENS HOLDER	2-D3	
	VE412900	DIOPTER CAM	2-C2	
	VE452300	FILTER SPACER	1-B2	
	VE526300	HOT SHOE HOLDER	1-C4	
	VE526400	HOT SHOE SPRING	1-C3	
	VE542400	DIOPTER DIAL	2-C3	
	VE633000	SHOE COVER	1-C3	
	VG013100	PUK SCREW 1.7X2B	1-D1	
	VG048800	FRONT COVER	1-A4	NEW
	VG048900	FRONT COVER(B)	1-A4	NEW
	VG049000	TB3 PCB	1-B3	NEW
	VG049100	TRIPOD SOCKET(B)	1-B3	NEW
	VG049200	FPC SPACER	1-C4	NEW
	VG049300	MODE DIAL UNIT(B)	2-B1	NEW
	VG049400	FLASH UNIT	2-C1	NEW
	VG049500	FLASH UNIT(B)	2-C1	NEW
	VG049600	JACK BASE	2-D4	NEW
	VG049700	JACK BASE(B)	2-D4	NEW
	VG049800	MODE DIAL UNIT	2-B1	NEW
	VG049900	SPEAKER PLATE	2-C3	NEW
	VG050000	PW2 PCB	2-D3	NEW
	VG050200	CCD LEAD	1-A2	NEW
	VG050300	TERMINAL CORD S	2-B4	NEW
	VG050400	DCT	2-C1	NEW
	VG050500	PW2 SPACER	2-D4	NEW
	VG050600	TB2 SHIELD	2-C4	NEW
	VG050700	REAR SPACER A	1-D2	NEW
	VG050800	REAR SPACER B	1-D1	NEW
	VG050900	TERMINAL CORD TB2	2-B3	NEW
	VG051000	FLAT SCREW1.6X4	1-B3	NEW
	VG051100	PUK SCREW 1.7X2	1-D1	NEW
	VG051200	PLATE TAPE	1-B2	NEW
	VG051300	LCD TAPE	1-B1,C2	NEW
	VG051400	BATTERY COVER	1-D4	NEW
	VG051500	BATTERY COVER(B)	1-D4	NEW
	VG051600	CA1 PCB	1-B3	NEW
	VG051700	CP1 PCB	1-C2	NEW
	VG051800	VIEW BUTTON(B)	1-C2	NEW
	VG051900	SELF BUTTON(B)	1-C2	NEW
	VG052000	TERMINAL COVER(B)	1-D4	NEW
	VG052100	LEAD INSULATION	1-C2	NEW
	VG052200	4KEY BUTTON(B)	1-C2	NEW
	VG052300	INSULATION LCD	1-A2	NEW
	VG052400	LCD PLATE	1-A1	NEW
	VG052500	MODE FPC	1-A1	NEW
	VG052600	MODE FPC(B)	1-A1	NEW
	VG052700	BATTERY CASE(B)	2-C3	NEW

PARTS LIST

C-770 Ultra Zoom

REF NO	PARTS NO	DESCRIPTION	REMARKS	NOTE
	VG052800	TB2 PCB	2-B4	NEW
	VG052900	SHEET TAPE	1-A2	NEW
	VG053000	SELF BUTTON	1-C2	NEW
	VG053100	COVER SHAFT	1-C4	NEW
	VG053200	BACK COVER	1-C1	NEW
	VG053300	TB1 PCB	2-A3	NEW
	VG053400	SW SHIELD	1-A1	NEW
	VG053600	PW1 PCB	2-A3	NEW
	VG053700	TERMINAL COVER	1-D4	NEW
	VG053800	BACK COVER(B)	1-C1	NEW
	VG053900	ST1 PCB	2-B4	NEW
	VJ608400	LENS ASSY	1-A3	
	VJ689100	LENS ASSY(B)	1-A3	